

BCD-3000

Mini Customer Display



Retail



Banking



Customer Service Center



Healthcare

Ideal for mPOS Display

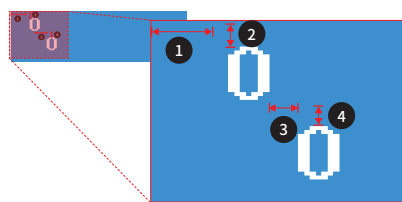
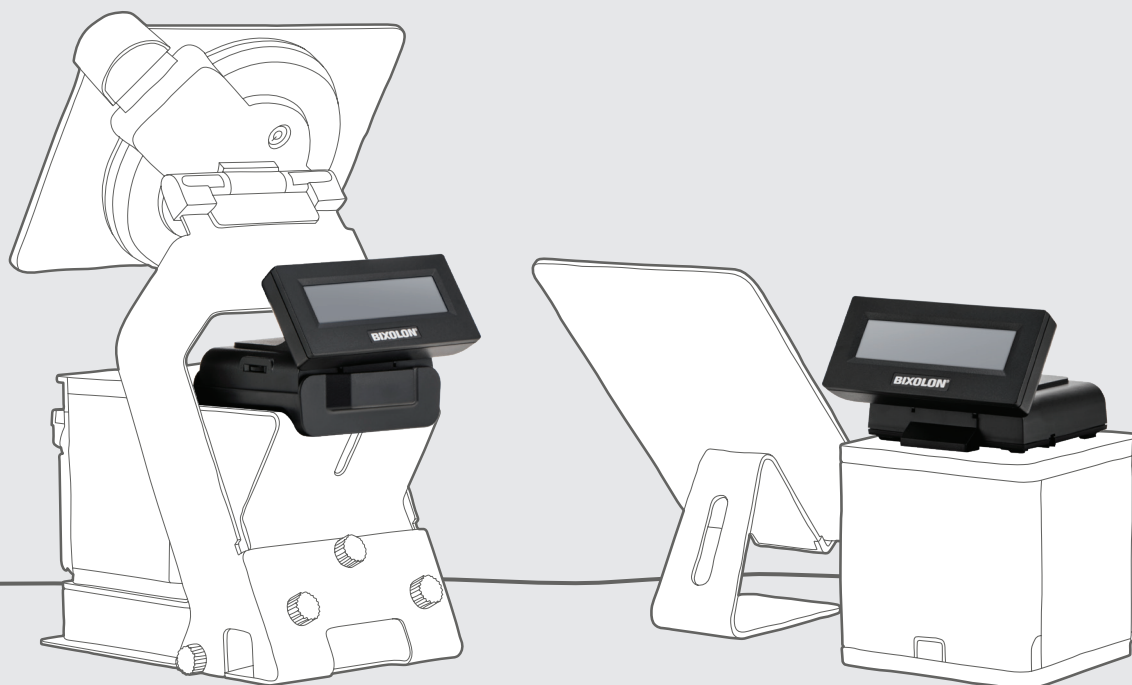

① Horizontal ② Vertical ③ Font space ④ line space

00000 00000	Center Alignment
00000 00000	Left Alignment
00000 00000	Right Alignment



Made for iPod iPhone iPad



Easy plug

Ultra-Compact

- Approximately 287% smaller than a standard customer display
- Multiple cable paths for user convenience

User-Friendly Performance

- Flexible character alignment on display (Horizontal, vertical, font space and line space)
- Adjust alignment (Center, left and right)
- Enhanced by mono LCD with variable brightness
- 250% advanced reliability as compared BCD-1000/1100
- Simple download and display image by utility
- Angle adjustable from 0 to 35°

Hardware Compatibility

- Easy plug and play USB set up
- Compatible with all major operating systems including Android™, iOS™ and Windows®



BIXOLON[®]
a Better Solution for your Business™

BCD-3000

Mini Customer Display

Specifications

Display

Display Method

STN LCD (mono)

Display Color

Blue / White

Active Area

96 x 19.2 mm

Visual Area

99 x 24 mm

Brightness

100 cd/m²

Character Number

20 Letters x 2 Lines

Character Type(Set)

95 Alphanumeric,

6 International

Character Font

8 x 16

Character Size

4.8 x 9.6 mm

Character Space

0.05 mm

Receive Buffer

1Kbytes

Emulation

ESC/POS, CD5220, UTC Standard,

UTC Enhance, PD6000

Power & Interface

Power - Voltage

USB: 5VDC±5% (USB Bus Power)

RS232: 5VDC±5%

Power - Current

500mA

Interface

RS232/USB

Software

Driver

Windows Driver, OPOS Driver

SDK

Windows SDK

Android SDK

iOS SDK

Exterior

Body Color

Ivory / Black

Rotation Angle

Vertical: 35°

Overall Dimension

130 x 110.3 x 68.5

Product weight

250 g

Environment & Reliability

Operating Temperature

0 ~ 40°C / 32 ~ 104°F

Operating Humidity

10 ~ 80%

Storage Temperature

-20 ~ 55°C / -4 ~ 131°F

Storage Humidity

10 ~ 90%

Reliability (Display)

50,000 hours (Backlight)

